

*"The steadfast love of the Lord never ceases;
his mercies never come to an end;
they are new every morning;
great is your faithfulness."
Lamentations 3:23*



Grace Baptist Church Move-back Guide August 2017

CONTENTS

1. Pastoral Sharing.....	3
2. Summary of Main Points	4
3. Our New Home: Getting There	5
4. Church Floor Plans	6
5. Car Park Traffic Management	11
6. Alternative Car Park Locations.....	13

1. PASTORAL SHARING

Since returning to Singapore some nine months ago, I have been absolutely amazed by God's outpouring of grace, which has been demonstrated by the sacrificial giving by so many. It is beyond my experience and frankly, it was beyond my imagination that a congregation our size might out-give the funding requirements of such a huge building project. Surely those who have championed and stewarded this project are deserving of our best encouragement and greatest gratitude!

By God's grace and your generosity, the Grace Baptist family will soon return to 17 Mattar Road. And then?

The building of the church will begin again in earnest!

Ephesians 2:19-22 reminds us that we, "are no longer strangers and aliens, but (we) are fellow citizens with the saints and members of the household of God, built on the foundation of the apostles and prophets, Christ Jesus himself being the cornerstone, in whom the whole structure, being joined together, grows into a holy temple in the Lord. In him (we) also are being built together into a dwelling place for God by the Spirit".

GBC, we have indeed been built—not upon concrete pilings and cement floors—but upon the lives and teaching of the apostles and prophets who have gone before us. Jesus is our living cornerstone. He is the one who establishes our shape and who qualifies us to represent him in his world. And he is continuing to grow us in holiness so that together, we might be an appropriate dwelling place for his Spirit's work. What an amazing thought that is!

As we return to Mattar Road and re-establish that address as a glorious platform for his gospel, let us return with great confidence, knowing that, "Christ is faithful over God's house as a son. And we are his house if indeed we hold fast our confidence and our boasting in our hope (Hebrews 3:6)." We return with joy at the great things he has done in us. Let us return with our confidence fully set on his refining work in us. And let us return boasting, not in our own accomplishments, but in the hope we have in the Good News of Jesus Christ!

To God be the glory, great things he has done, and will do in the exciting years to come!

Pastor Ian

2. SUMMARY OF MAIN POINTS

1. We start Sunday activities at Mattar Road church premises on Sunday 20 August 2017.
2. Sunday activities timings
 - English Worship Service: 9.00 -10.30am
 - EC Discipleship Seminars: 11am – 12.15pm
 - EC Sunday School: 10.30am – 12.00pm
 - Chinese Worship Service: 11am – 12.30pm
3. For those taking public transport, please refer to Section 4 for the bus stop locations and bus service numbers. The nearest MRT station is Mattar; it is situated on the Downtown Line and will be operational from 21 October 2017. Other nearby MRT stations are MacPherson (Circle Line) and Aljunied (East-West Line).
4. For those driving to church, there will be traffic marshals on site to assist with car park management for the first month of our move-back. If the church car park is full, please park your car at alternative car parks located on the map in Section 6.
5. Email all feedback and comments to future@gracebaptistchurch.sg. Alternatively you can inform the church office administrative staff.

3. OUR NEW HOME: GETTING THERE

Mattar MRT Station

Downtown Line (Stage 3)

Operationally ready on 21 October 2017

Bus Stop No. B70029

Aljunied Road

Bus Services: 62, 64, 100

Bus Stops No. B70151 & B70161

Merpati Road

Bus Services: 40, 61, 63, 65, 66, 135, 154, 155, 158



Bus Stop No. B70021

Aljunied Road

Bus Services: 61, 62, 64, 65, 66, 100, 135, 154, 155

Bus Stops No. B70241 & B70231

Mattar Road

Bus Services: 40, 61, 63, 65, 66, 135, 154, 155, 158

4. CHURCH FLOOR PLANS

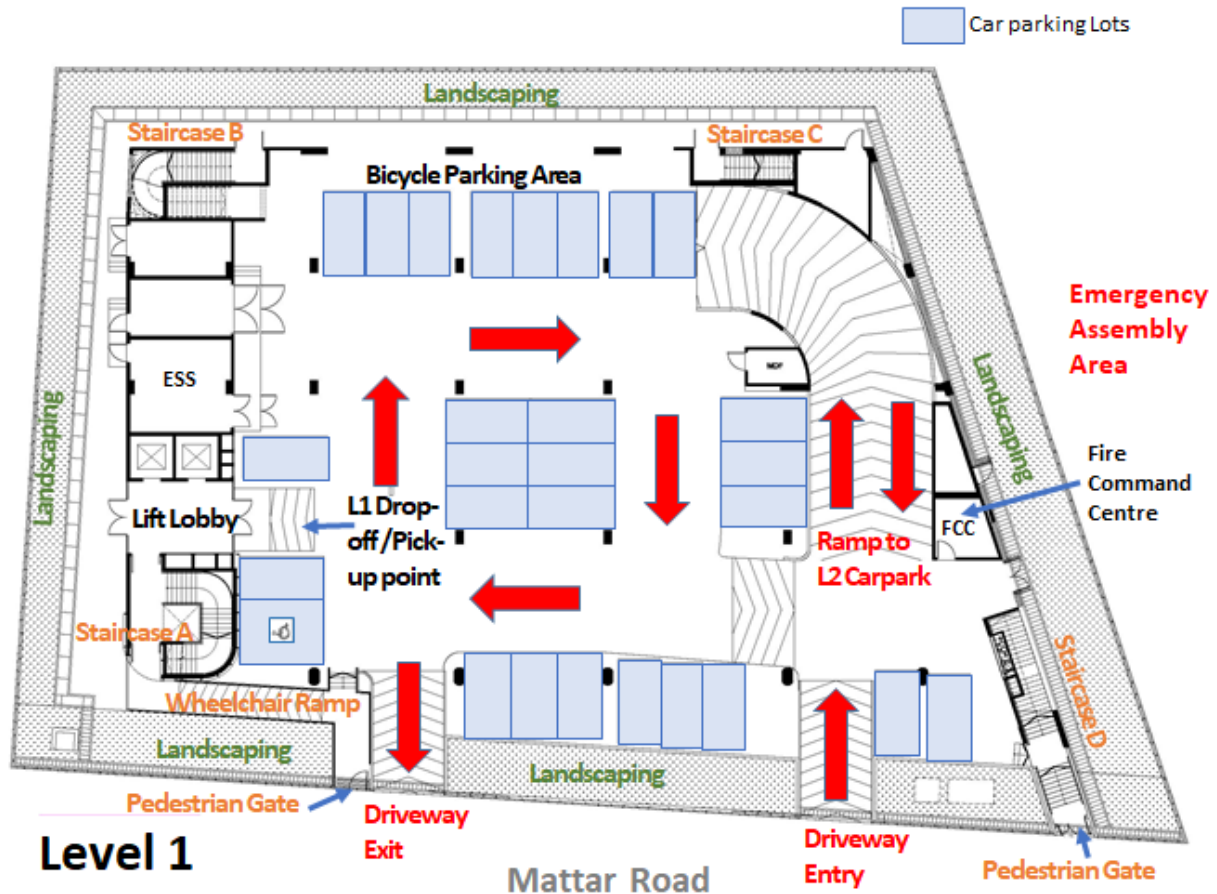

- This level contains the lift lobby, dropoff/pickup areas, carparking (including handicap lot) and bicycle parking areas, and the vehicular ramp to level 2. There are also service areas like the FCC and ESS here.
- There is one vehicular entrance to and exit from the driveway and two pedestrian gates for foot traffic on either side of the driveway.
- On weekends all gates and internal doors will be open. During weekdays, the main gates will be open during church office hours, however, the ramp to level 2 will be shuttered so all parking will be on level 1. Access through internal doors on weekday office hours will be via registered fingerprint access or someone in the church office will buzz you in when you ring the doorbell.
- This level is served by staircases A-D.

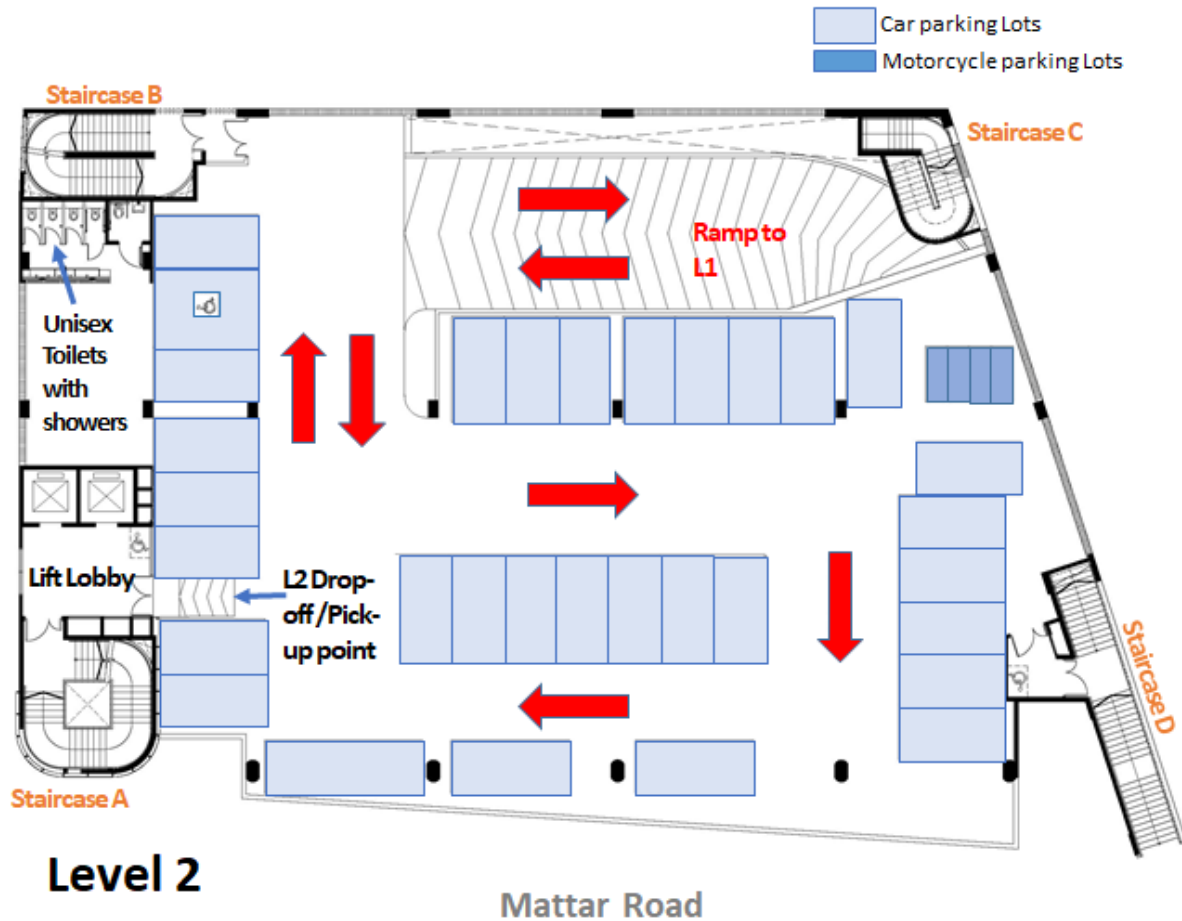

- This level contains the lift lobby, dropoff/pickup areas, carparking (including handicap lot) and motorcycle parking areas.
- There is a bank of 4 shared toilets with showers.
- This level is served by staircases A-D.



- This level contains the lift lobby, an open fellowship hall, pantry, library, church office, meeting rooms 301-310 (room 310 can be partitioned into 4 smaller rooms), and ladies and gents toilets.
- There is a hot/cold water dispenser and a drink vending machine installed outside the pantry.
- Level 3 features an open-air balcony area overlooking Mattar Road.
- This level is served by staircases A-D. Staircase E leads up to level 4 where the Sanctuary is.

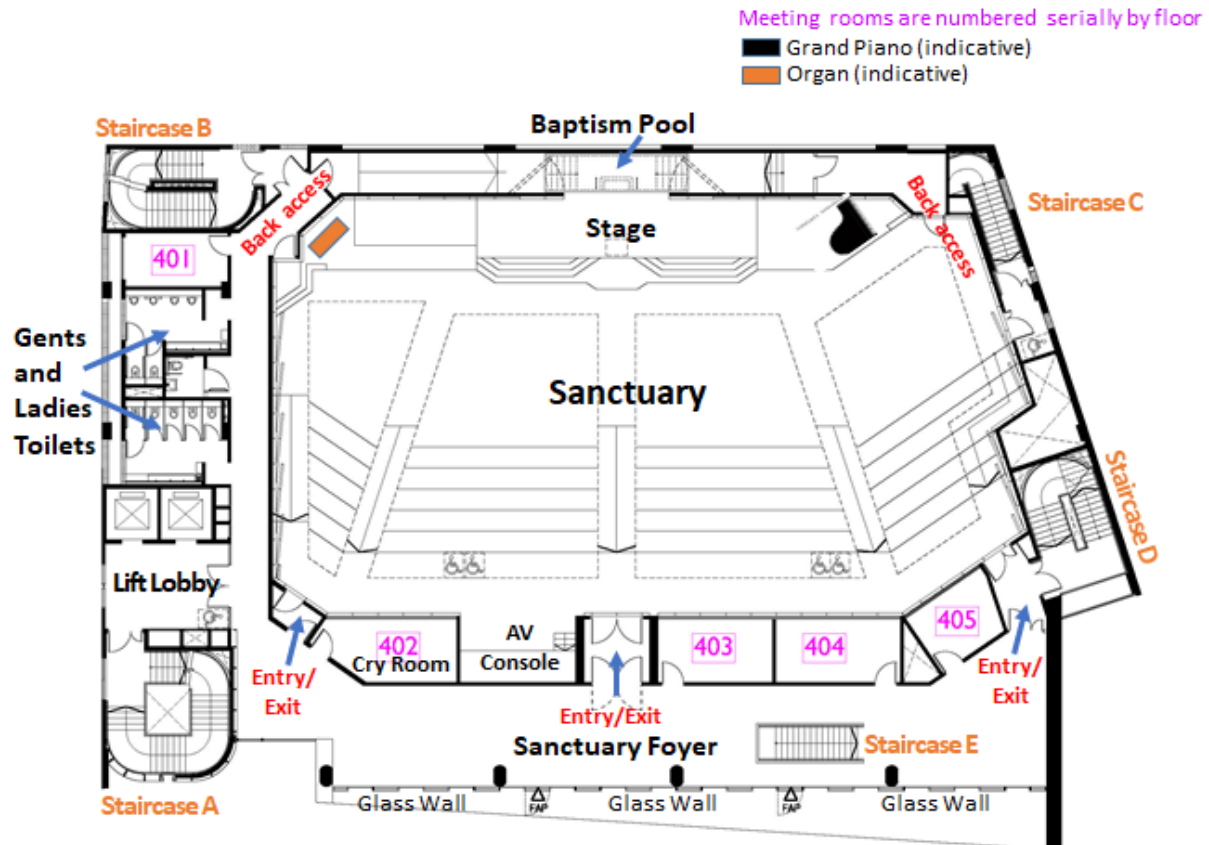

Level 4

Mattar Road

- This level contains the lift lobby, the Sanctuary, cry room and prayer rooms 403-405. Room 401 is a preparation room that can be used for occasions like baptisms and concerts.
- There is a bank of ladies and gents toilets here.
- This level is served by staircases A-D. Staircase E leads down to level 3 where the fellowship hall is.

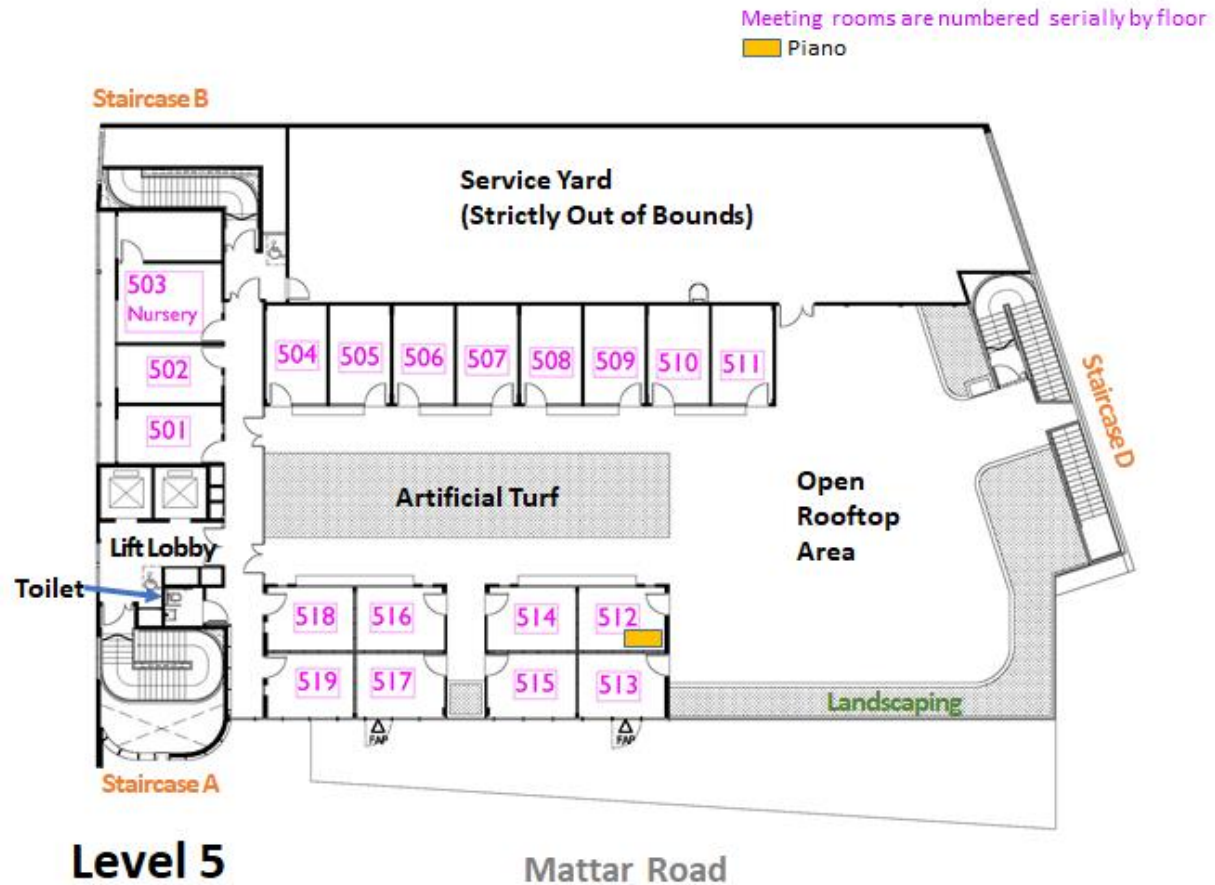

- This level contains the lift lobby, meeting rooms 501-513, and an open landscaped area.
- There is one handicap-friendly toilet here. The other toilets are available on level 4.
- The service yard is located here. It is fenced off and accessible only to authorised persons.
- This level is served by staircases A, B and D.

5. CAR PARK TRAFFIC MANAGEMENT

1. Traffic marshals will be available at strategic points for the first month after we move back to the new premises to assist drivers and facilitate smooth traffic flow. Please follow their instructions closely.
2. There is only 1 entrance and 1 exit designated for all vehicles at all times.

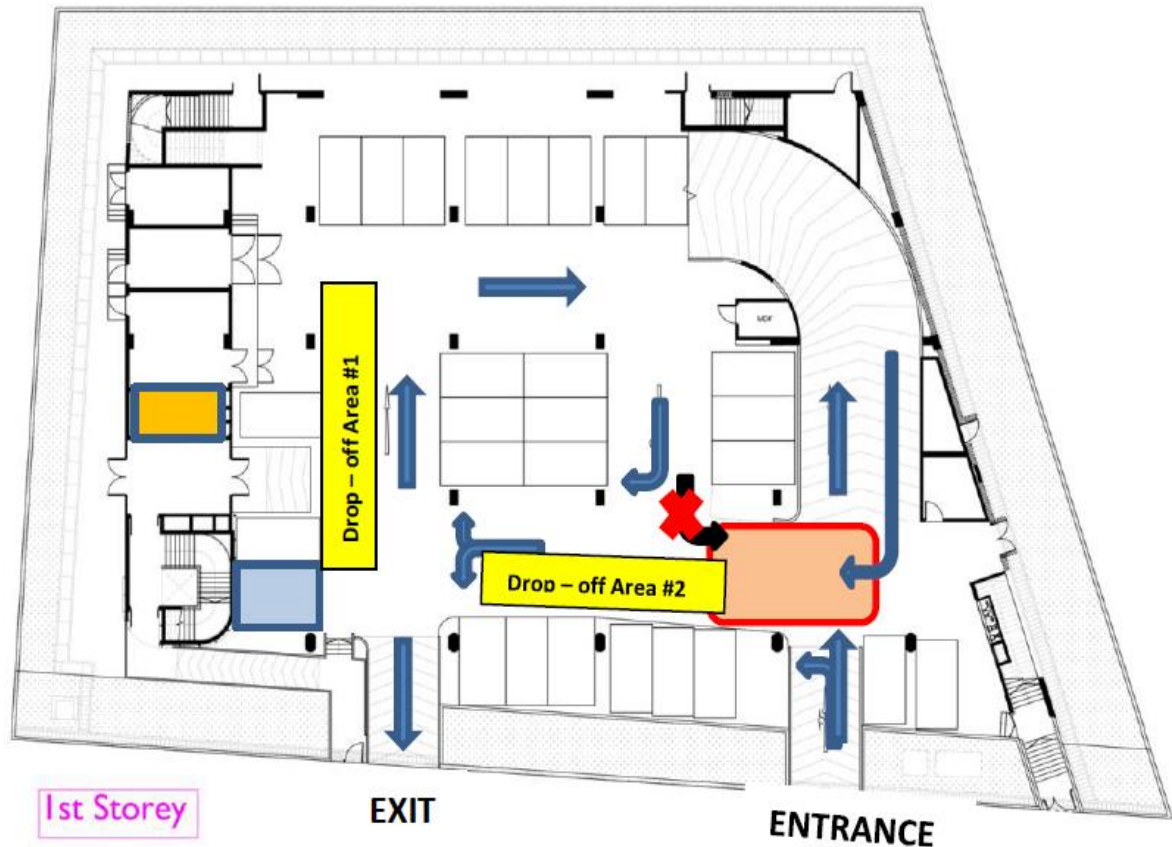

3. Within the car park on both levels, there is only 1 designated traffic flow pattern for all vehicles. Please adhere to this pattern strictly.
4. Please park in only marked parking lots. No tandem parking is allowed.
5. Please alight at the 2 designated drop-off areas at level 1.
6. There will be an electronic counter installed on the carpark ramp leading to level 2. This will indicate the number of vacant car park lots on level 2. Please **do not** drive up the ramp to level 2 if the counter indicates no more vacant lots.

7. As there are only 60 car park lots (inclusive of 2 disabled accessible lots) on 2 levels of car park, please park your car in the alternative car park locations should there be no more available lots.
8. Bicycle parking spaces are available on level 1 and motorcycle parking spaces, on level 2.

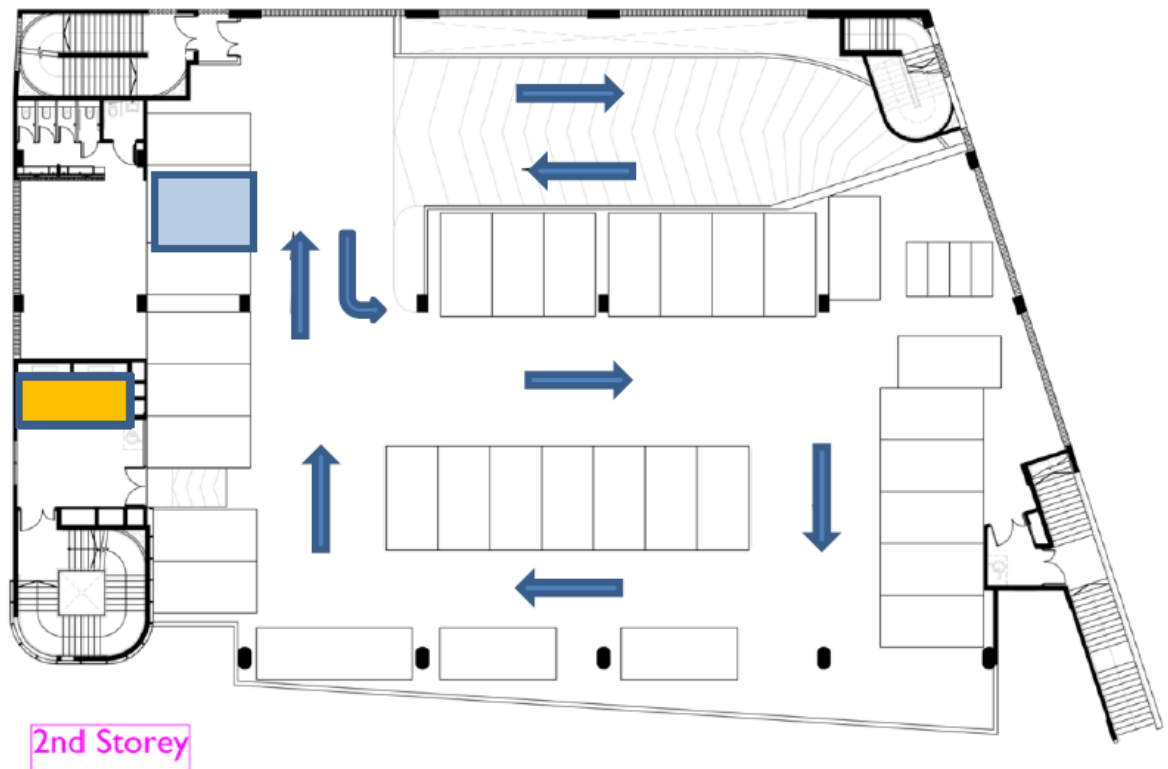

6. ALTERNATIVE CAR PARK LOCATIONS

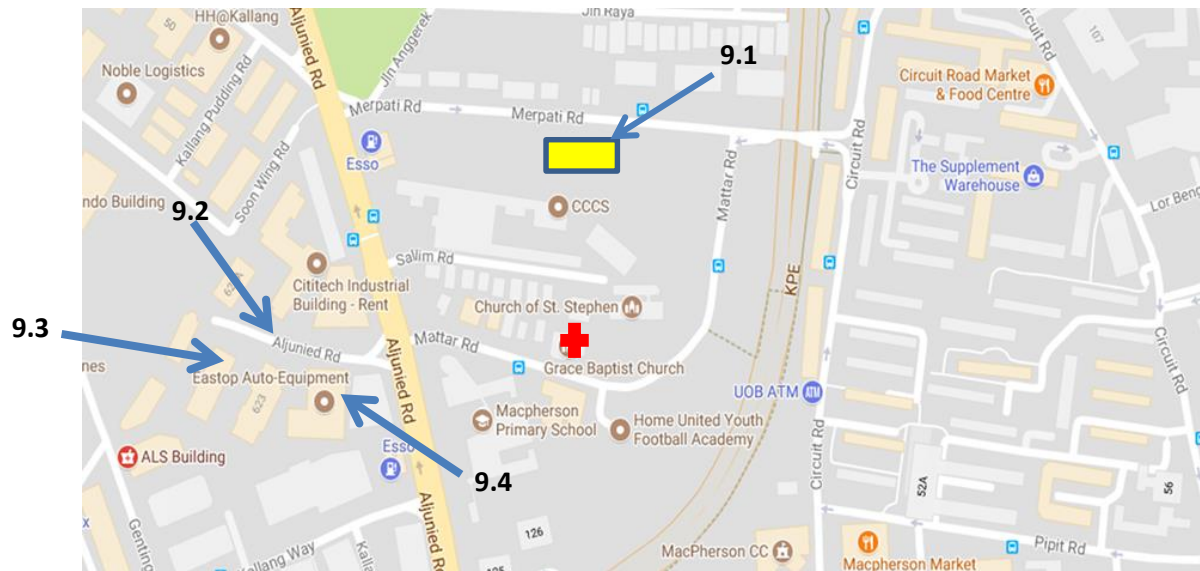

- 9.1 Public Open car-park along Merpati Road next to Mattar MRT station.
 - a. 95 lots
 - b. Free parking on Sunday
- 9.2 Public carpark lots along both sides of Aljunied Road (opposite the Mosque - across the main road) towards Pacific Building - Free parking on Sunday.
- 9.3 Car parking at 625, Aljunied Industrial Complex. Rate: \$1.20 per entry on Sunday.
- 9.4 Car parking at 621, Lippo Building. Rate: \$1.20 per hour.